

## Sit-On-Attachment for Hoverboard Self-Balancing Scooter – HoverSeat .



### ***NOW WITH UNIVERSAL ADAPTER THAT FITS ALMOST ALL HOVERBOARDS ON A MARKET!***

The HoverSeat is a light aluminum frame which fits easily in the trunk of the car. When you want to use it, simply attach it to your hoverboard with the specially designed universal adaptor with pedals.

- Attach your favorite beach chair to the platform, relax, and drive! Perhaps you prefer a folding boat chair, a cooler, a storage box with a cushion, or something else? Any box or seat that can stand on a flat surface and is strong enough to support your weight can be installed on top of platform.
- Navigate the hoverboard using only your feet; it can even reverse. This HoverSeat can be used on or off-road, and can ride over grass, gravel, and packed sand when attached off road hoverboard.
- HoverSeat is ideal for a cooler box that is strong enough to sit on. Use HoverSeat to tow a wheeled cart and then transport bags, boxes, groceries, or a paddle board, or use it to transport heavy or awkward tools. The hoverboard sit-on attachment is strong enough to pull a kayak down to the beach.

**Thank you for purchasing sit-on-attachment for hoverboard HoverSeat. Please see YouTube videos available on a web page where you had purchased this product for additional information, set up and tips.**

**IMPORTANT:** Please make sure all bolts are properly tightened and there are no loose parts before using HoverSeat. To avoid fall and injury, please make sure that seating arrangement that you are using with HoverSeat are securely connected to frame with optional adjustable tie downs or straps. If it a beach chair, it must be secured with provided Velcro straps.



**Do NOT stand on HoverSeat while riding. Do NOT ride on hoverboard standing with HoverSeat attached. Do NOT overload, max weight is 230lbs. Do NOT ride on a roads were cars are present. Be always prepared to stop. Helmet, knee and elbow pads are required while riding hoverboard sit-on attachment.**

**ASSEMBLY:** To assemble, first secure axle tube to main frame with provided bolts. Then insert forward pull tube into adaptor welded to the axle, and secure with bolt, as well as to front part of main frame. Slide wheels over axles and secure with spring pins. Install pedal adapter over hoverboard and secure with Velcro straps. Slide bolt on top of clamp through hole in forward pull tube and secure with provided wing nut.

## Sit-On-Attachment for Hoverboard Self-Balancing Scooter – HoverSeat .

Please note that once adapter is mounted on top of hoverboard, and hoverboard is powered on, it immediately engage pressure sensors under hoverboard footpads, essentially telling hoverboard that someone is standing on top of it, and it ready to go. Hoverboard can start moving forward or backward without warning, as long as directional pressure applied to it. Therefore it is imperative to keep hoverboard in its "neutral" (horizontal footpads) position to avoid its to start moving without warning, while getting in or getting out. Please first turn hoverboard power on, then make sure it horizontal, and only then sit on a HoverSeat.

Attach seating of your choice to the HoverSeat. We recommend regular beach chair for best comfort. Secure front leg of beach chair to sit-on attachment with provided Velcro strips, so that chair will not move on top and can't flip backward when moving. For best safety secure seating to platform with optional tie downs or straps. Do not use stretchable bungee cords or rubber cords.

**RIDING:** To start forward movement, place both feet on pedals, move slightly forward, and slowly tilt feet down. Hoverboard will start moving forward. To stop or reverse, simply tilt feet backward. Start riding slowly and then try to stop, just to get feeling how to operate safely. Do not go fast, learn how to move forward and stop. Hold on to chair in case if hoverboard stop suddenly, as you might slide forward in this case. To make turns, simply tilt only one foot toward direction you want to turn. There is might be short learning curve to operate HoverSeat, but generally anyone can do it.

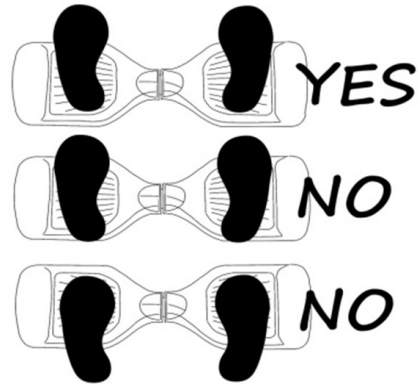

**UNIVERSAL HOVERBOARD ADAPTER FIT OVER MOST HOVERBOARDS, EXCEPT THOSE THAT HAVE HANDLE OVER CENTER. PLEASE SEE BELOW FOR EASY ASSEMBLY INSTRUCTION. PLEASE VISIT DEALER WEB SITE FOR MORE INFO.**

1. SLIDE PEDALS OVER MAIN TUBE
2. SECURE WITH WASHERS AND BOLT AS SHOWN

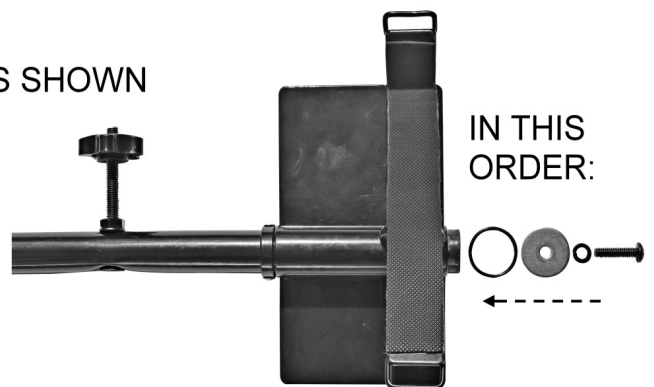
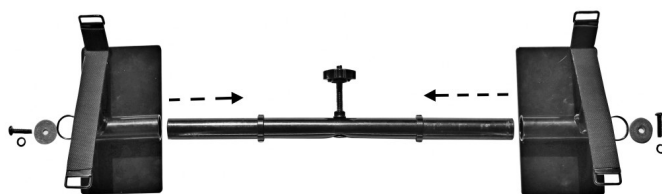

3. PLACE ADAPTER OVER HOVERBOARD



4. SECURE WITH VELCRO STRAPS